

Open Research Online

The Open University's repository of research publications and other research outputs

European Co-ordinated Quadrangle Mapping of Mercury

Conference or Workshop Item

How to cite:

Rothery, David; Galluzzi, Valentina and Wright, Jack (2020). European Co-ordinated Quadrangle Mapping of Mercury. In: Planetary Geologic Mappers 2020, LPI Contributions, article no. 7022.

For guidance on citations see [FAQs](#).

© 2020 The Authors



<https://creativecommons.org/licenses/by/4.0/>

Version: Version of Record

Link(s) to article on publisher's website:

<http://dx.doi.org/doi:10.5281/zenodo.5091679>

<https://www.hou.usra.edu/meetings/pgm2020/pdf/7022.pdf>

Copyright and Moral Rights for the articles on this site are retained by the individual authors and/or other copyright owners. For more information on Open Research Online's data [policy](#) on reuse of materials please consult the policies page.

EUROPEAN CO-ORDINATED QUADRANGLE MAPPING OF MERCURY

David A. Rothery¹, Valentina Galluzzi², Jack Wright¹, ¹School of Physical Sciences, The Open University, Milton Keynes, MK7 6AA, UK (david.rothery@open.ac.uk, jack.wright@open.ac.uk), ²INAF, Istituto di Astrofisica e Planetologia Spaziali (IAPS), Rome, Italy 9 (valentina.galluzzi@inaf.it)

ABSTRACT

MESSENGER data are being used to create 1:3M quadrangle geologic maps of Mercury [1], in preparation for BepiColombo [2]. Maps H02-H05 have already been published [3-6] and others are in progress [e.g. 7-12] or scheduled with the exception of H01 (Figure 1). Mapping uses 166 mpp mosaics, and digitization is at a scale of 1:300k. The mapper for each quadrangle maps a 5° overlap with adjacent quadrangles, and it will be possible to produce a globally merged product. Mapping protocols follow the mapping standards document of the Planmap project [13], which are modelled closely on the USGS equivalent.

References: [1] Galluzzi V. et al. (2019) *Geophys. Res. Abs.*, 21, EGU2019-18802-1. [2] Rothery D. A. et al. (2020) *Space Sci. Rev.*, 216, 66. [3] Galluzzi V. et al. (2016), *J. Maps*, 12, 227–238. [4] Guzzetta, L. et al. (2017) *J. Maps*, 13, 227–238. [5] Mancinelli et al. (2016) *J. Maps*, 12, 190–202. [6] Wright J. et al. (2019) *J. Maps*, 15, 509–520. [7] Giacomini L. et al. (2018), *EPSC 12*, EPSC2018-721-1. [8] Lewang A.M. et al. (2018), *LPS XLIX*, Abstract #1846. [9] Malliband C.C. et al. (2019), *LPS L*, Abstract #1807. [10] Semenzato A. et al. (2018), *EPSC 12*, EPSC2018-344. [11] Pegg D.L. et al. (2019), *LPS L*, Abstract #1271. [12] Man et al. (2020), *British Planetary Sci Conf.* 2020, 80. [13] <https://wiki.planmap.eu/pages/viewpage.action?pageId=4980741>

Acknowledgments: MESSENGER data are publicly available on the PDS. This project has received funding from the European Union's Horizon 2020 research and innovation program under grant agreement No 776276 and the Italian Space Agency (ASI) under ASI-INAF agreement 2017-47-H.0.

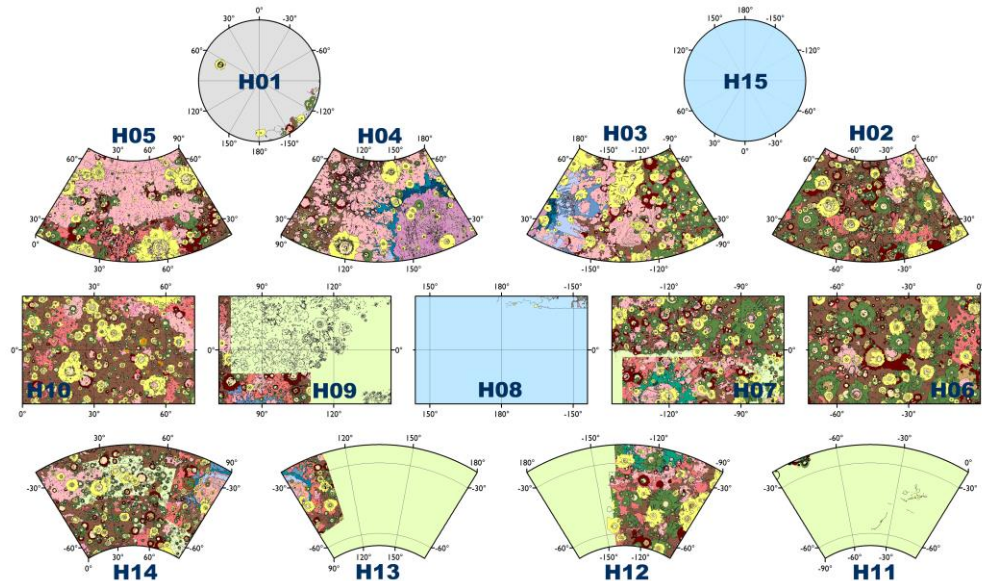

Figure Caption: The status of European quadrangle mapping on Mercury. Maps in the equatorial and southern rows are not yet published. H10 and H14 are expected in 2020. Green = in progress, blue = scheduled.